

## STANDARD DATA BNC 75Ω RF CONNECTORS

|                            |                                 | VALUE                                   |                                     |                                 |
|----------------------------|---------------------------------|---|-------------------------------------|---------------------------------|
| GENERAL CHARACTERISTICS    | Mating                          | Bayonet Lock                            |                                     |                                 |
|                            | Cable Attachment                | Crimp - Crimp                           |                                     |                                 |
|                            | Environmental                   | Complies with RoHS Directive 2002/95/EC |                                     |                                 |
| ELECTRICAL CHARACTERISTICS | Impedance                       | 75Ω                                     |                                     |                                 |
|                            | Frequency Range                 | 0 - 1 GHz                               |                                     |                                 |
|                            | Voltage Rating                  | 500V RMS                                |                                     |                                 |
|                            | Dielectric withstanding voltage | 1500 Volts RMS                          |                                     |                                 |
|                            | VSWR                            | 1.05 + 0.1f(GHz) DC to 1 GHz            |                                     |                                 |
|                            | Contact Resistance              |   |                                     |                                 |
|                            | Centre Contact                  | 1.5 milliohm                            |                                     |                                 |
|                            | Outer Contact                   | 1.0 milliohm                            |                                     |                                 |
| Insulation Resistance      | 5000 MΩ (min.)                  |   |                                     |                                 |
| MATERIALS                  |                                 | Part                                    | Material                            | Finish                          |
|                            |                                 | Body, Coupling sleeves                  | Brass                               | Nickel                          |
|                            |                                 | Crimp Ferrule                           | Annealed Copper                     | Nickel                          |
|                            |                                 | Male Contact                            | Brass                               | Gold                            |
|                            |                                 | Female Contact                          | Beryllium Copper or Phosphor Bronze | Gold                            |
|                            |                                 | XLR Housing                             | Diecast Zinc Alloy                  | Satin Nickel or Black Polyester |
|                            |                                 | Insulators                              | Teflon or Delrin                    | Natural                         |

Rev 2 - 09/2005

**NOTE:** These characteristics are typical and may not apply to all connectors.

## PANEL CUTOUTS - FRONT VIEW

AC-BNC-PJ-75  
AC-BNC-JJ-75

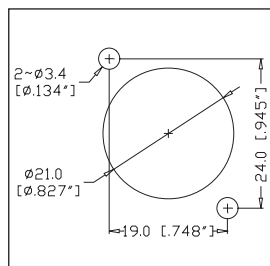

AC-BNC-PJA-75  
AC-BNC-JJA-75

