

ASSEMBLY INSTRUCTION PI 1071 HP SERIES CABLE CONNECTOR

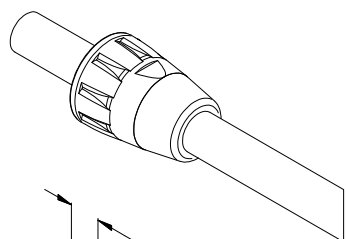

1. SLIDE THE NUT ONTO THE CABLE

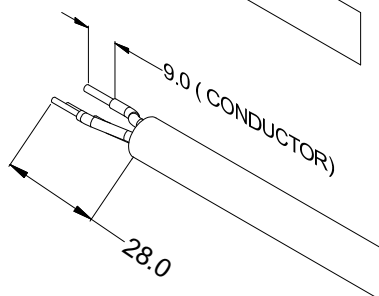

2. STRIP THE CABLE AS DIMENSIONS SHOWN AND TWIST THE CONDUCTORS.

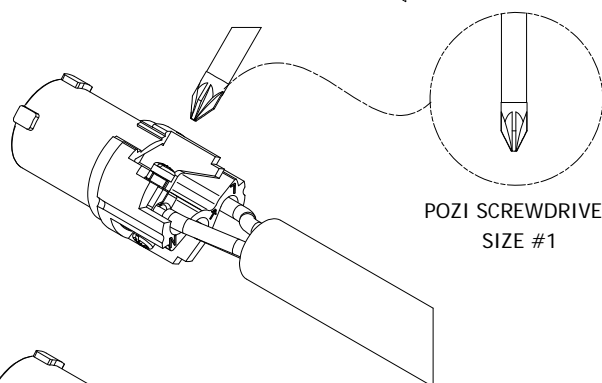

POZI SCREWDRIVER
SIZE #1

3. INSERT THE CONDUCTORS INTO THE REAR OF CONTACTS ON THE INSERT. TIGHTEN THE SCREWS TO 0.35 Nm (3.0 lb-in) USING A POZI SCREWDRIVER OF SIZE #1.

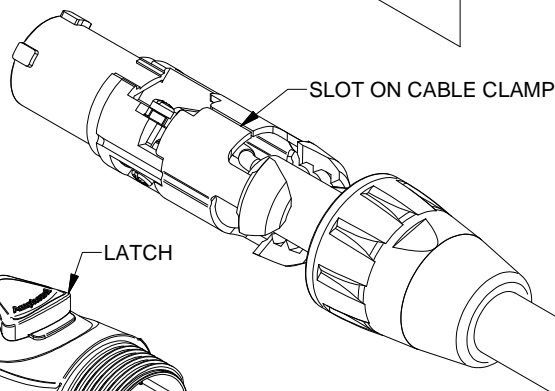
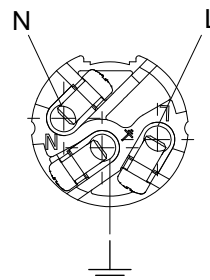

SLOT ON CABLE CLAMP

4. INSTALL THE CABLE CLAMP, FLUSH TO THE INSERT MAKING SURE TO ALIGN THE SLOT AS SHOWN IN THE PICTURE.

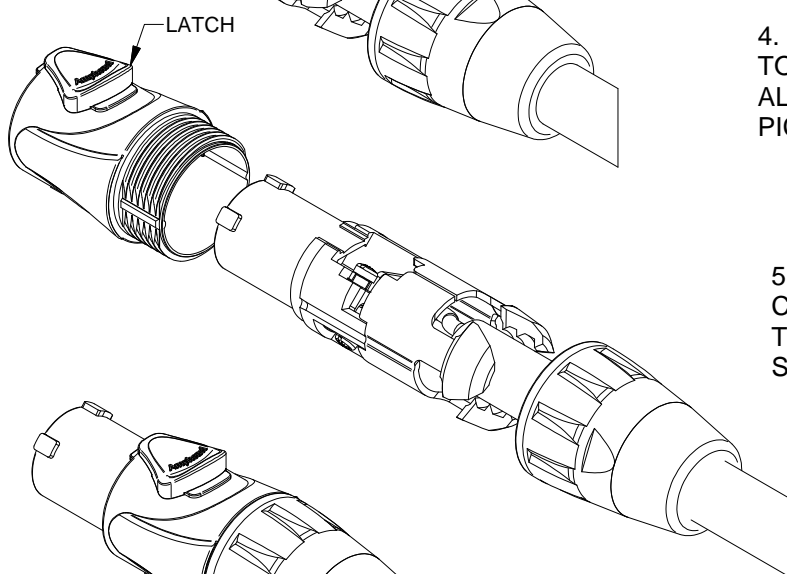

LATCH

5. ORIENTATE THE INSERT AND CABLE CLAMP AS SHOWN THEN PUSH ALL TOGETHER INTO THE CONNECTOR SHELL

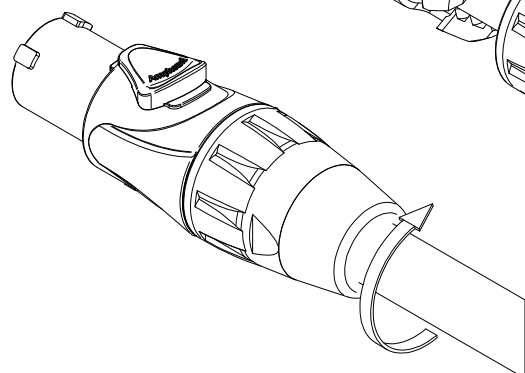

6. THREAD THE NUT ONTO THE SHELL TO ACTIVATE THE CABLE CLAMP AND CLOSE THE CONNECTOR ASSEMBLY.