

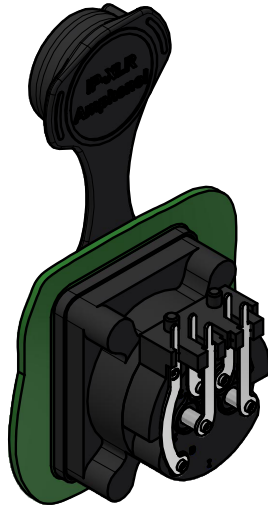

CAPPED VIEW

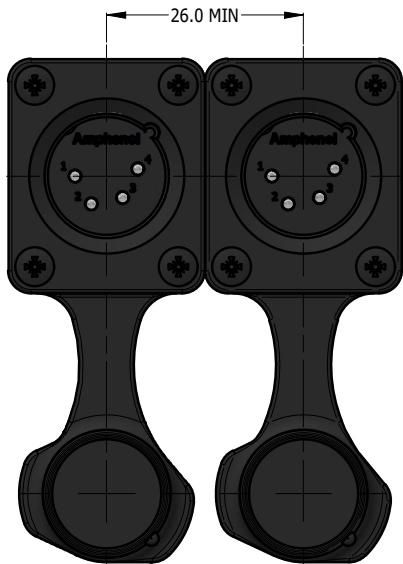

REAR VIEW

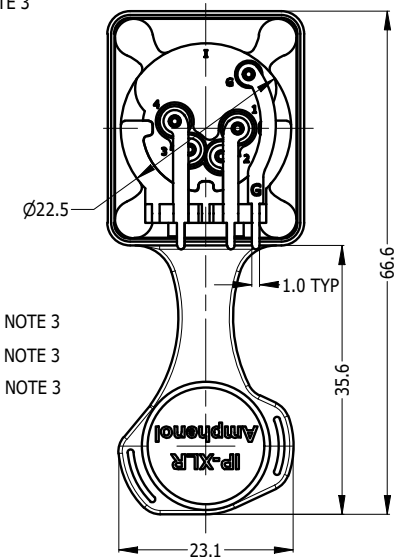
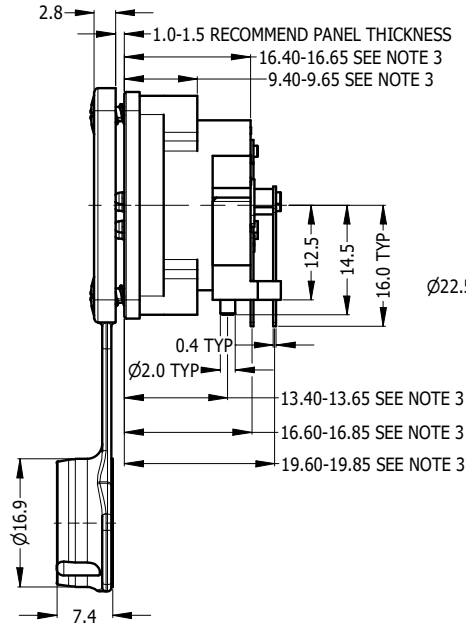
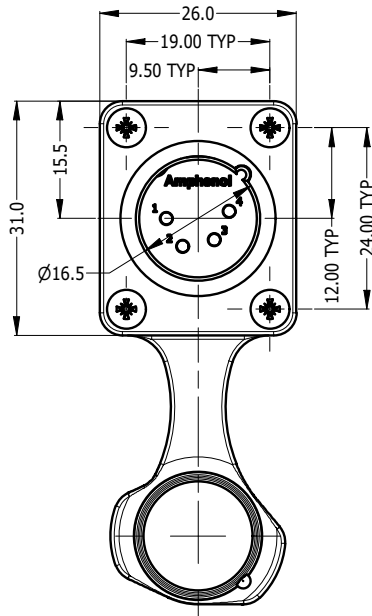

RECOMMEND MINIMUM MOUNTING PITCH

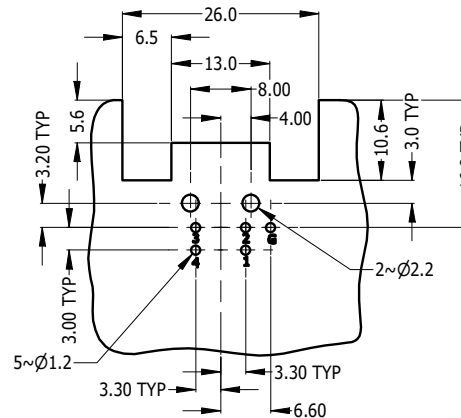
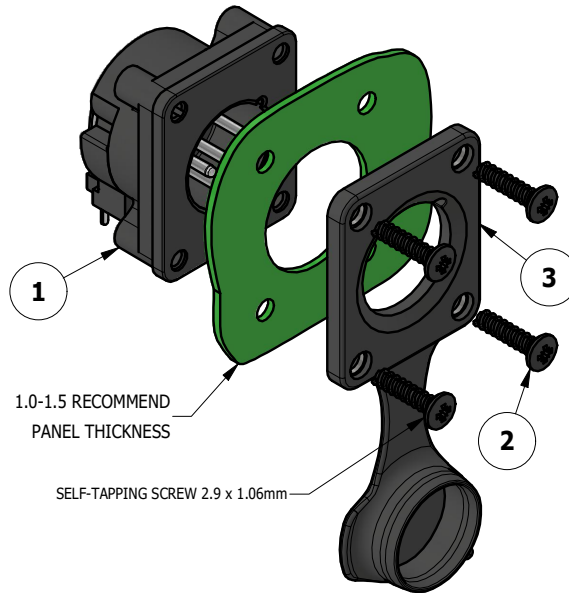

RECOMMEND PCB LAYOUT
CONNECTOR SIDE

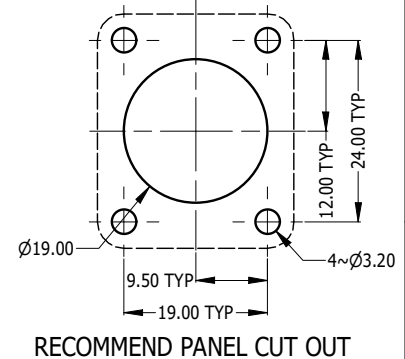

RECOMMEND PANEL CUT OUT

| REVISION HISTORY | | | | |
|------------------|-------------|----------|----|------|
| REV | DESCRIPTION | DATE | BY | ECN |
| 1 | FIRST ISSUE | 11-11-23 | MH | ---- |

NOTE:
 1. MATING CONNECTOR SHELL TO HAVE MIN 1.6 SURFACE FINISH TO ACHIEVE IP RATING OF THIS CONNECTOR.
 2. BLACK MOUNTING SCREW 52500011-430 x 4 PCS TO BE SUPPLIED WITH THE CONNECTOR, MAX TORQUE 0.5Nm.
 3. DUE TO 0.4mm THICK RUBBER SEAL, THE DIM WILL VARY DEPENDING ON THE SCREWS TIGHTENING IN ASSEMBLY.

| ITEM | PART NUMBER | DESCRIPTION | QTY |
|------|------------------|---|-----|
| 3 | 52730035-000 | AXS FRONT FLANGE D TYPE RUBBER SEAL IP54 WITH CAP | 1 |
| 2 | 52500011-430 | SCREW 2.9 x 1.06mm USED FOR PLASTIC MATERIAL | 4 |
| 1 | 55011501-004/904 | AXS4MPH WITHOUT RUBBER FLANGE - TIN/GOLD PLATED CONTACT | 1 |

| UNLESS OTHERWISE SPECIFIED TOLERANCE TO BE | |
|--|-------------|
| LINEAR | ANGULAR |
| X ± 0.5 | X' ± 1 |
| X.X ± 0.2 | X.X' ± 30' |
| X.XX ± 0.1 | X.XX" ± 15' |

BREAK ALL SHARP EDGES AND REMOVE ALL BURRS
 DO NOT SCALE

DIMENSIONS IN MILLIMETRES

THIS DOCUMENT IS THE PROPERTY OF AMPHENOL AUSTRALIA PTY. LTD.
 NO PART THEREOF MAY BE REPRODUCED AND USED WITHOUT THE PRIOR WRITTEN CONSENT OF THE OWNER

MATERIAL: **SEE COMPONENT**

FINISH: **SEE COMPONENT**



THIRD ANGLE PROJECTION

DRN: M.H DATE: 11-11-23

CKD: M.H DATE: 11-11-23

APP'D: P.M DATE: 11-11-23

SCALE: **1:1** SIZE: **A4**

Amphenol Amphenol Australia Pty.Ltd,
 22 Industry Blvd, Carrum Downs, VIC 3201

TITLE:
**AXS4MPH
 AXS PANEL MOUNT SERIES
 CUSTOMER DRAWING**

PART No.
SEE TABLE
 DRAWING No.
55011501-804-2 SHEET
2/2

| PART NUMBER | CONTACT FINISH |
|-------------|----------------|
| AXS4MPH | TIN PLATED |
| AXS4MPH-AU | GOLD PLATED |